



Main Features:

- Material: Alloy steel
- Rated Capacities: 50klb~100klb
- OIML NTEP HB44, CE and RoHS certified
- IP Rating: IP68
- Suitable for truck scale, heavy duty hopper scales and other electronic weighing devices.
- High precision by NTEP III L 10000, high reliability.

Product description:

DB923A is a double ended shear beam, both ends loaded, center supported via self-aligning semicircular groove structure, so that the force can be applied properly. This load cell is suitable for a wide range of truck scales, giant vessel scales and rail scales. It is designed to be lifted via a pair of parallel connected ring at both ends. Fully alloy steel construct, hermetically sealed, which ensure high seals performance of waterproof.

Dimensions (mm&inch):

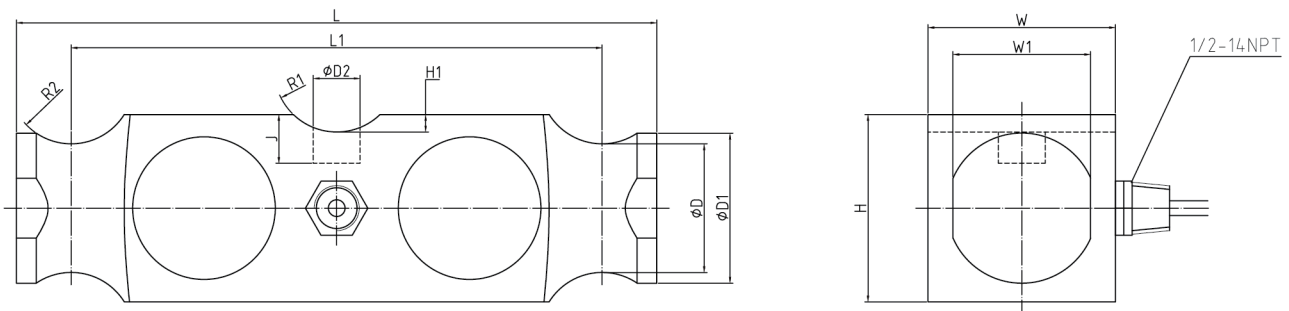

Rated Capacity	L	L1	W	W1	H	H1	φD	φD1	φD2	J	R1	R2
50K-100K	10.25	8.50	3.00	2.20	3.00	0.28	2.06	2.40	0.75	0.78	1.00	1.00

DB923A Double Beam Load Cell Specifications

Parameter	Units	Specifications	
Model No.		DB923A	
Rated capacity (E _{max})	lbs	50K; 75K; 100K	
Accuracy class ¹⁾²⁾	% of E _{max}	± 0.02	
Min. dead load	lb	0	
Rated output	mV/V	3.0 ± 0.1%	
Zero balance	% of E _{max}	± 1	
Repeatability error	% of AL ³⁾	< ± 0.05	
Creep; 30 minute	% of AL	< ± 0.02	
Min. dead load output return (DR); 30 min	% of AL	< ± 0.02	
Temp. effect on	Min. dead load output	% of E _{max} /°C	< ± 0.002
	Rated output ²⁾	% of AL/°C	< ± 0.002
Temperature range	Compensated		-10 to +40 [+14 to +104]
	Operating	°C(°F)	-40 to +65 [-40 to +149]
	Safe storage		-40 to +80 [-40 to +176]
Excitation voltage	Recommended	V AC/DC	5 ~ 15
	Maximum		15
Terminal resistance	Excitation	Ω	766 ± 10
	Output		700 ± 3
Insulation resistance @50VDC	MΩ		> 5000
Breakdown voltage	V AC		> 500
Seal type / IP rating			Hermetically welded / IP68
Load limit	Safe	% of E _{max}	150
	Ultimate		200
Material	Spring element		Alloy steel nickel plated
	Cable		Φ6; 4-wire; PVC
Cable length	ft		52.5
Weight; approx	lb		20.0
Fatigue life	cycles @E _{max}		> 1,000,000
Deflection at E _{max} ; approx	mm		< 1.5

Notes:

¹⁾ Error due to the combined effect of non-linearity and hysteresis

²⁾ The sum of errors due to Temperature Effect on Output comply with the requirements of OIML R60 and NIST HB44

³⁾ AL = Applied Load

Cable Colour Code: (4-wire circuit)

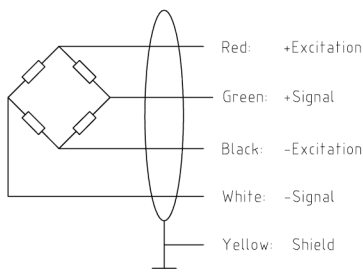

Shield connected to load cell body

Interchangeable Products:

Manufacturer	Model
Vishay Revere transducers	5223
Rice lake	RL75223